

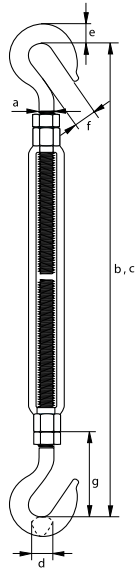

G-6312



## Green Pin® HH Turnbuckle

Turnbuckle with hook-hook end-fitting, generally to ASTM1145-92

- **Material:** drop forged high tensile steel SAE 1035 or 1045
- **Safety factor:** MBL equals 5 x WLL
- **Standard:** generally to ASTM F1145-92  
formerly U.S. Federal Specification FF-T-791b
- **Finish:** hot dipped galvanized
- **Certification:** 2.1 2.2 3.1 MTC<sup>a</sup> CE

working load limit	diameter thread	take up	length closed position	length open position	thickness hook	thickness hook	opening hook	length closed position	weight each
t	a inch	inch	b mm	c mm	d mm	e mm	f mm	g mm	kg
0.54	3/8	6	278	415	13	16	15	42	0.53
1	1/2	6	305	434	16	22	16	48	0.93
1	1/2	9	380	587	16	22	16	47	1.16
0.68	1/2	12	456	739	13	19	16	47	1.34
1.59	5/8	6	356	479	16	23	21	67	0.98
1.59	5/8	9	431	632	20	24	21	66	1.96
1.59	5/8	12	507	784	16	23	21	66	1.71
2.36	3/4	6	393	511	22	27	24	79	1.53
1.36	3/4	9	468	664	20	27	24	78	1.88
2.36	3/4	12	544	816	22	27	24	78	3.27
2.36	3/4	18	696	1122	22	27	24	78	4.5
2.27	1	6	479	586	26	35	31	109	3.87
4.54	1	12	625	886	26	35	31	106	6.64
2.27	1	18	778	1191	26	35	31	106	6
2.27	1	24	928	1495	26	35	31	105	7.52

In inch

working load limit	diameter thread	take up	length closed position	length open position	thickness hook	thickness hook	opening hook	length closed position	weight each
t	a inch	inch	b inch	c inch	d inch	e inch	f inch	g inch	lbs
0.54	3/8	6	10 <sup>15/16</sup>	16 <sup>11/32</sup>	1/2	5/8	19/32	1 <sup>11/16</sup>	1.17
1	1/2	6	12	17 <sup>1/8</sup>	5/8	7/8	5/8	1 <sup>29/32</sup>	2.05
1	1/2	9	14 <sup>15/16</sup>	23 <sup>1/8</sup>	5/8	7/8	5/8	1 <sup>7/8</sup>	2.56
0.68	1/2	12	17 <sup>31/32</sup>	29 <sup>3/32</sup>	1/2	3/4	5/8	1 <sup>7/8</sup>	2.95
1.59	5/8	6	14	18 <sup>7/8</sup>	5/8	29/32	13/16	2 <sup>5/8</sup>	2.16
1.59	5/8	9	17	24 <sup>7/8</sup>	25/32	15/16	13/16	2 <sup>19/32</sup>	4.32
1.59	5/8	12	19 <sup>31/32</sup>	30 <sup>13/16</sup>	5/8	29/32	13/16	2 <sup>19/32</sup>	3.77
2.36	3/4	6	15 <sup>1/2</sup>	20 <sup>1/8</sup>	7/8	1 <sup>3/32</sup>	15/16	3 <sup>1/8</sup>	3.37
1.36	3/4	9	18 <sup>7/16</sup>	26 <sup>1/8</sup>	25/32	1 <sup>3/32</sup>	15/16	3 <sup>3/32</sup>	4.14
2.36	3/4	12	21 <sup>7/16</sup>	32 <sup>1/8</sup>	7/8	1 <sup>3/32</sup>	15/16	3 <sup>3/32</sup>	7.21
2.36	3/4	18	27 <sup>3/8</sup>	44 <sup>3/8</sup>	7/8	1 <sup>3/32</sup>	15/16	3 <sup>3/32</sup>	9.92
2.27	1	6	18 <sup>7/8</sup>	23 <sup>3/32</sup>	1 <sup>1/32</sup>	1 <sup>3/8</sup>	1 <sup>1/4</sup>	4 <sup>9/32</sup>	8.53
4.54	1	12	24 <sup>19/32</sup>	34 <sup>7/8</sup>	1 <sup>1/32</sup>	1 <sup>3/8</sup>	1 <sup>1/4</sup>	4 <sup>5/32</sup>	14.64
2.27	1	18	30 <sup>19/32</sup>	46 <sup>29/32</sup>	1 <sup>1/32</sup>	1 <sup>3/8</sup>	1 <sup>1/4</sup>	4 <sup>5/32</sup>	13.23
2.27	1	24	36 <sup>17/32</sup>	58 <sup>3/4</sup>	1 <sup>1/32</sup>	1 <sup>3/8</sup>	1 <sup>1/4</sup>	4 <sup>1/8</sup>	16.58